

Sheraton Gateway Hotel Atlanta Airport

1900 Sullivan Road Atlanta, Georgia 30337
T 770-997-1100 sheraton.com/atlantaairport



Second Floor



Room Dimensions & Seating Capacity

Room	Size	Feet	Height	Conf.	Recep.	Banquet	Theatre	Class	U-Shape
International Ballroom	108' x 82'	8,470	16'	1,200	1,200	600	900	450	-
LO London	46' x 30'	1,380	16'	30	100	70	110	51	26
AM Amsterdam	39' x 30'	1,380	16'	30	120	80	120	55	30
PA Paris	78' x 24'	1,672	16'	60	90	120	120	90	50
BR Brussels	43' x 46'	2,019	16'	35	150	120	150	90	35
FR Frankfurt	43' x 39'	2,019	16'	35	170	140	160	100	40
LO/AM	78' x 35'	2,730	16'	64	220	150	250	120	50
LO/AM/PA	78' x 56'	4,368	16'	64	300	240	400	210	80
BR/FR	78' x 43'	3,354	16'	80	320	220	300	180	95
PA/BR/FR	86' x 67'	5,762	16'	85	400	340	500	280	105
Island Suite	80' x 30'	2,400	10'	80	200	120	250	100	60
BA Bahamas	30' x 30'	900	10'	25	50	40	60	33	25
BE Bermuda	30' x 20'	600	10'	18	40	40	50	30	20
JA Jamaica	30' x 30'	900	10'	25	50	40	60	33	25
BA/BE	50' x 30'	1,500	10'	50	100	90	120	70	55
BE/JA	50' x 30'	1,500	10'	50	100	90	120	70	55
MT Magnolia Terrace	50' x 25'	1,250	Outside	-	60	50	-	-	-
CA Cancun	26' x 19'	494	12'	18	40	40	50	21	20
MC Mexico City	23' x 19'	437	12'	16	30	30	40	18	15
EB Executive Boardroom	26' x 19'	494	8'	14	-	-	-	-	-
CO Cozumel	24' x 16'	389	9'	10	20	20	30	10	12

Sheraton Gateway Hotel Atlanta Airport

1900 Sullivan Road Atlanta, Georgia 30337
T 770-997-1100 sheraton.com/atlantaairport

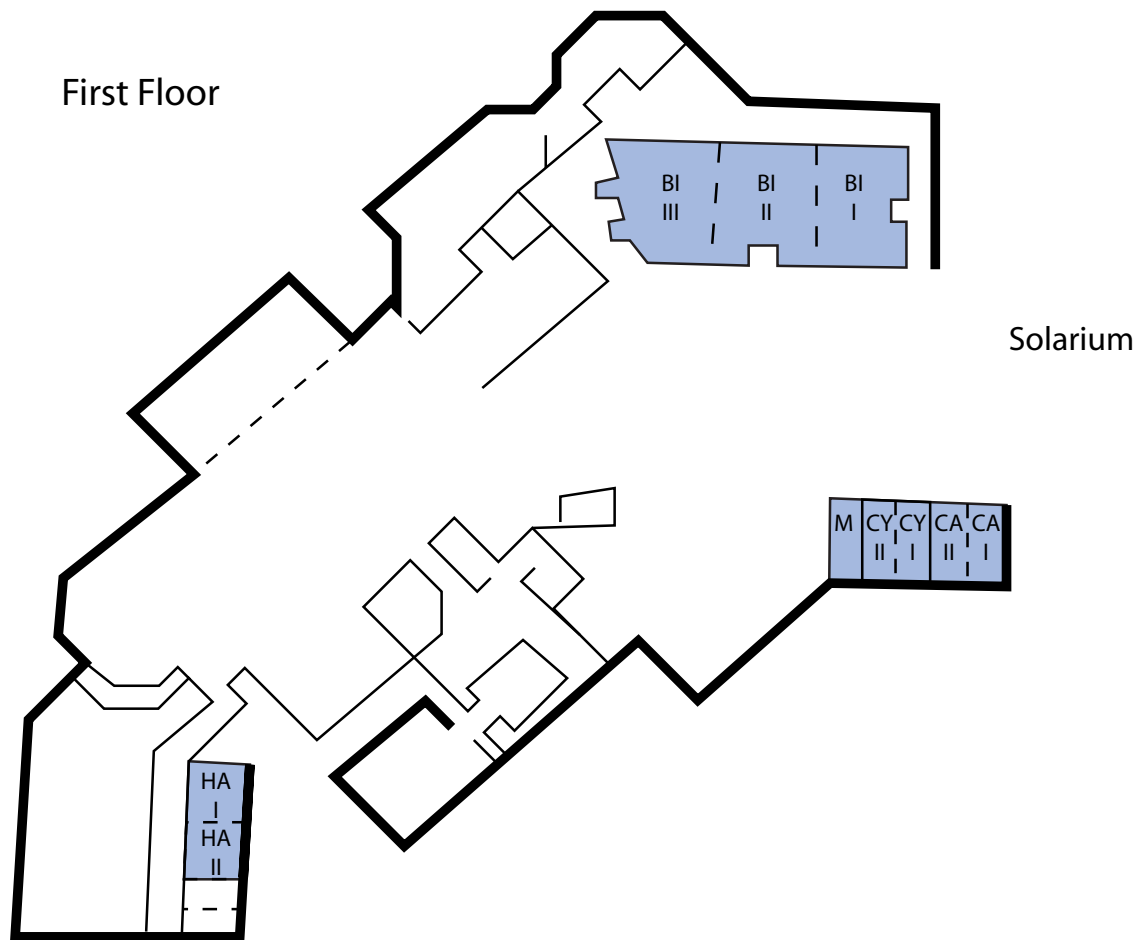

Room Dimensions & Seating Capacity

Room	Size	Feet	Height	Conf.	Recep.	Banquet	Theatre	Class	U-Shape
BI Biltmore I, II, III	98' x 56'	6267	13'8"	-	500	300	350	200	-
BI Biltmore I	32' x 63'	2035	13'8"	40	160	90	155	70	30
BI Biltmore II	39' x 60'	2319	13'8"	50	200	100	175	90	50
BI Biltmore III	32' x 60'	1913	13'8"	40	140	80	90	60	30
BI Biltmore I + II	68' x 64'	4352	13'8"	80	360	200	200	120	80
BI Biltmore II + III	68' x 62'	4216	13'8"	80	340	200	200	120	80
CY Cyprus I, II	34' x 23'	906	12'	22	40	40	60	36	25
CY Cyprus I	17' x 23'	451	12'	12	20	20	30	14	10
CY Cyprus II	17' x 23'	455	12'	12	20	20	30	14	10
M Malta	17' x 23'	442	12'	12	20	20	30	12	12
CA Capri I, II	30' x 23'	785	12'	22	30	40	60	30	22
CA Capri I	15' x 23'	388	12'	12	15	20	30	12	10
CA Capri II	15' x 23'	397	12'	12	15	20	30	12	10
HA Hartsfield I	22' x 22'	484	9'	20	50	40	50	24	21
HA Hartsfield II	24' x 18'	432	9'	18	40	30	35	21	15
Solarium	95' x 76'	7220	-	-	350	230	300	175	-